

Gynecological Specialty Instruments

German Engineered Euro-Med® Instruments

Handcrafted to exacting standards by the world's preeminent steel artisans, Euro-Med stainless steel surgical instruments represent a higher level of engineering, control and precision. Essential for the success of women's health procedures, these instruments are ideal for doctors and practices who use only the best to ensure exceptional results.

Classic Series
Tischler-Morgan™
Biopsy Punch

Euro-Med® Biopsy Punches	18
Euro-Med® Stainless Steel Specula	24
Stainless Steel Lateral Wall Retractors	26
Stainless Steel Sounds and Dilators	27
Stainless Steel Curettes.....	28
Stainless Steel Tenacula and Hooks	29
Stainless Steel Endocervical Specula.....	30
Stainless Steel Forceps	30
Stainless Steel Needle Holders	34
Stainless Steel Scissors.....	35

5 Year Complimentary
Sharpening On Our
Classic Series™
Biopsy Punches.

Euro-Med® Stainless Steel Biopsy Punches

Beautifully Balanced for Superior Handling, Response and Comfort

Tischler-Morgan™ Biopsy Punch

CA* CE



Also Available
in 25 cm Length

Our most popular design includes ergonomic contours for maximum control and comfort. The standard bite incorporates a single tooth on the upper and lower jaws that draws tissue in for maximum sample retention with minimal trauma.

Number	Length	Bite	
64-689	21 cm	7 mm x 3 mm	<input type="checkbox"/>
64-689L	25 cm	7 mm x 3 mm	<input type="checkbox"/>

Tischler-Kevorkian™ Biopsy Punch

CA* CE

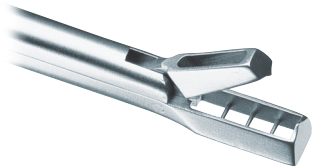

This classic large rectangular bite includes upper and lower teeth for added traction and maximum sampling.

Number	Length	Bite	
64-679	20 cm	9.5 mm x 3 mm	<input type="checkbox"/>

Mini-Townsend™ Biopsy Punch

CA* CE

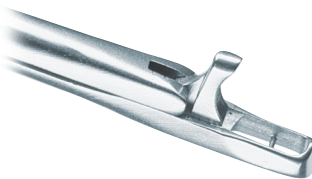

The petite bite minimizes trauma and is perfect for obtaining samples of lesions just inside the lip of the endocervical canal.

Number	Length	Bite	
64-690	20 cm	4.2 mm x 2.3 mm	<input type="checkbox"/>

Baby Tischler Biopsy Punch

CA* CE



Also Available
in 25 cm Length

Our popular Euro-Med handle grants optimal comfort, while the small bite incorporates a tooth permitting sampling at the endocervical canal. This variation of the Mini-Townsend provides samples with minimal patient discomfort and bleeding.

Number	Length	Bite	
64-691	20 cm	4.2 mm x 2.3 mm	<input type="checkbox"/>
64-691L	25 cm	4.2 mm x 2.3 mm	<input type="checkbox"/>

Kevorkian-Pacific™ Biopsy Punch

CA* CE



A slightly smaller bite and additional anchoring teeth on the bottom jaw ensure ample, well-oriented samples with minimal trauma.

Number	Length	Bite	
64-675	21 cm	8 mm x 3 mm	<input type="checkbox"/>

Coppleson Biopsy Punch

CA* CE



The unique jaw shape yields a distinct sample orientation for histologic analysis.

Number	Length	Bite	
64-660	21 cm	7.5 mm x 3 mm	<input type="checkbox"/>

Burke™ Biopsy Punch

CA* CE



Burke Biopsy
Punch Handle

The design features an open handle for even the largest of hands and an oval-shaped bite for small samples. Sharp tooth design helps to anchor the tissue for sampling and retention.

Number	Length	Bite	
64-677	21 cm	5.5 mm x 3.25 mm	<input type="checkbox"/>

Baggish Biopsy Punch

CA* CE

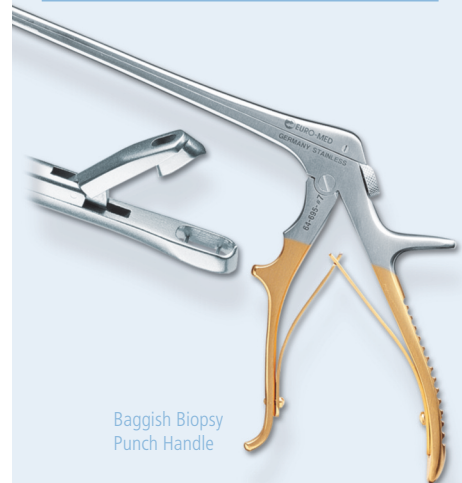

Baggish Biopsy
Punch Handle

Another variation of the open-handle design, this punch provides a larger, oval-shaped bite. The jaws have two bottom teeth and a serrated bed to provide optimal retention of tissue samples.

Number	Length	Bite	
64-695	21 cm	6.5 mm x 3.5 mm	<input type="checkbox"/>

Euro-Med® Colposcopy Biopsy Instrument Sets

Our Euro-Med Colposcopy Sets feature the instruments most necessary for successful procedures. Each set comes with the four basic colposcopy hand instruments. Reap the rewards of our ready-made sets consisting of our most popular product combinations, or customize a kit to best serve your needs. Each set consists of a biopsy punch, an endocervical speculum, a curette and a hook.

Colposcopy Biopsy Instrument Sets

CA* CE

Number	Description
KIT-A	Kit A Contents: Tischler-Morgan™ Punch, Euro-Med Endocervical Speculum, Emmett Tenaculum, Kevorkian Collector™ Curette
KIT-B	Kit B Contents: Burke™ Biopsy Punch, Burke Endocervical Speculum, Iris Hook, Kevorkian Curette with Basket
KIT-C	Kit C Contents: Mini-Townsend™ Punch, Burke Endocervical Speculum, Iris Hook, Townsend™ Curette
KIT-F	Mix & Match: choose one of each – Biopsy Punch, Endocervical Speculum, Curette and Hook



Euro-Med Keys Vulvar Punch Set and Singles

CA* CE

This essential set includes six stainless steel interchangeable tips ranging from 3 mm to 7 mm in diameter, and a universal handle, all set in a brass tray fitted in a wooden box for simple storage. The individual tips can be placed on the threaded handle as required. The brass insert facilitates set sterilization. Also available: individual "singles" permanently attached to their own handle.

Number	Length
68-180	Set includes: five tips, storage tray and wooden box
68-173	3 mm – Singles
68-174	4 mm – Singles
68-175	5 mm – Singles
68-176	6 mm – Singles
68-178	8 mm – Singles

Euro-Med® Rotating Biopsy Punch Handles

A 360-Degree Rotating Shaft Allows
Sample Collection from Any Angle

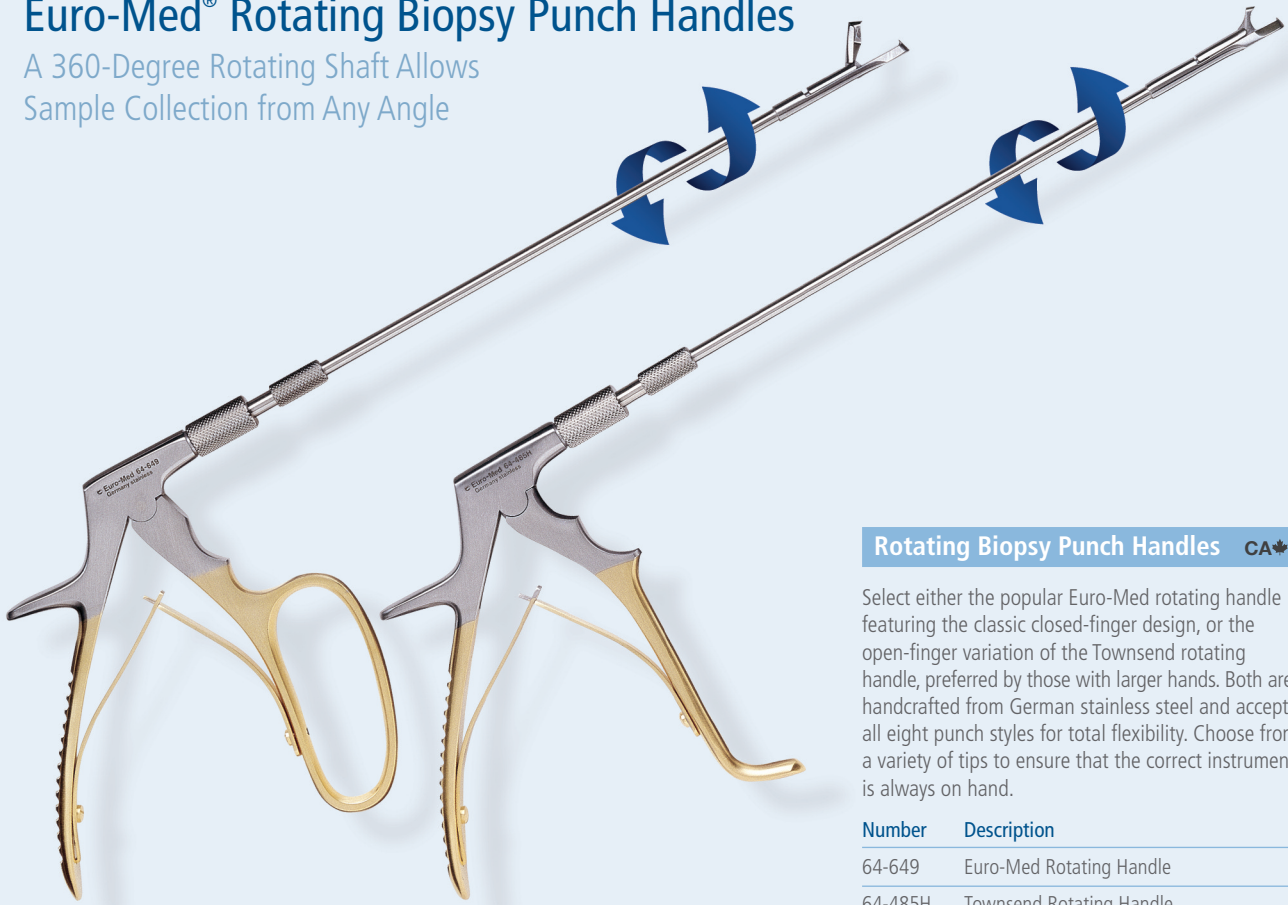

Euro-Med Rotating Handle

Townsend Rotating Handle

Rotating Biopsy Punch Handles CA* CE

Select either the popular Euro-Med rotating handle featuring the classic closed-finger design, or the open-finger variation of the Townsend rotating handle, preferred by those with larger hands. Both are handcrafted from German stainless steel and accept all eight punch styles for total flexibility. Choose from a variety of tips to ensure that the correct instrument is always on hand.

Number	Description
64-649	Euro-Med Rotating Handle
64-485H	Townsend Rotating Handle

These rotating punch tips fit either the Euro-Med® closed rotating handle or the Townsend open rotating handle. With eight tips to select from, complete customization is possible.

Tischler-Morgan Tip CA* CE



Number	Length	Bite
64-484	23 cm	7 mm x 3 mm

Tischler Tip Up CA* CE



Number	Length	Bite
64-751	23 cm	7 mm x 3 mm

Tischler Tip Down CA* CE



Number	Length	Bite
64-756	23 cm	7 mm x 3 mm

Mini Tip Up CA* CE



Number	Length	Bite
64-651	23 cm	4.2 mm x 2.3 mm

Mini Tip Down CA* CE



Number	Length	Bite
64-656	23 cm	4.2 mm x 2.3 mm

Mini-Townsend™ CA* CE



Number	Length	Bite
64-460	23 cm	4.2 mm x 2.3 mm

Oval Tip CA* CE



Number	Length	Bite
64-489	23 cm	5 mm x 3 mm

Kevorkian Tip CA* CE



Number	Length	Bite
64-488	23 cm	8 mm x 3 mm

To place an order, call us at: 800.243.2974 | Visit us online at: www.CooperSurgical.com

Euro-Med® Standard Biopsy Punches

These Supplemental Punch Designs Provide Consistent Performance and Enable Collection of High-Quality Samples



Handle for Eppendorfer, Wittner and Kevorkian Tips

Handle for Schubert Tip

Eppendorfer Tip CA* CE

One of the classic original biopsy designs, this oval cutting jaw obtains an 8 mm x 4 mm cervical specimen. A special basket in the jaw helps retain the biopsy sample.



Number	Length	Bite
64-687	19 cm	8 mm x 4 mm

Kevorkian Tip CA* CE

Offering the popular Kevorkian bite, a strong and narrow jaw and an added 7.5 cm shaft length, this punch facilitates simple insertion and sampling of the cervical canal, especially in patients for whom the extra length is necessary.



Number	Length	Bite
64-685	26.5 cm	8 mm x 3 mm

Wittner Tip CA* CE

The unique angle of the jaw enables extra access to hard-to-reach areas of the cervix. The large teeth and strong bite provide a maximum area of tissue sample.

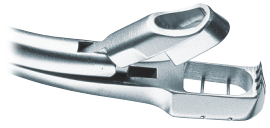

Number	Length	Bite
64-681	21.5 cm	8 mm x 4 mm

Schubert Tip CA* CE

One of the more popular biopsy punches used in Europe, the Schubert features a large bite and an angled handle to apply maximum pressure.



Number	Length	Bite
64-670	21.5 cm	8 mm x 4.5 mm

Engineered to Exacting Standards

Stainless Steel Specula for Exceptional Visibility and Access

Fundamental? Yes. Basic? Far from it. Euro-Med® provides the essentials for any practice, like our complete array of premium-grade stainless steel specula. Each instrument is designed to ensure your patient's comfort and meet your practice's needs. Ask us about our specially coated stainless steel specula and other instruments used during LEEP procedures (see pages 48-50).



Specula Blades and Yoke Dimensions

Use our convenient speculum sizing guide to help you easily select the proper tools for your practice. Specula are available in a variety of sizes to accommodate all your patients' needs.

In addition, we are now offering a range of extra-large to 4X size specula to facilitate examinations and procedures for larger or obese patients.

See pages 24-25 for a full product selection and model numbers.

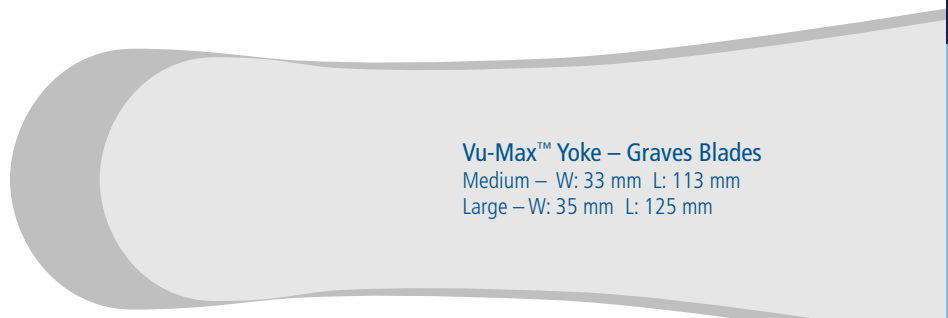

Vu-Max™ Yoke – Graves Blades
Medium – W: 33 mm L: 113 mm
Large – W: 35 mm L: 125 mm



Vu-Max Yoke – Pederson Blades
Medium – W: 22 mm L: 114 mm
Large – W: 26 mm L: 121 mm

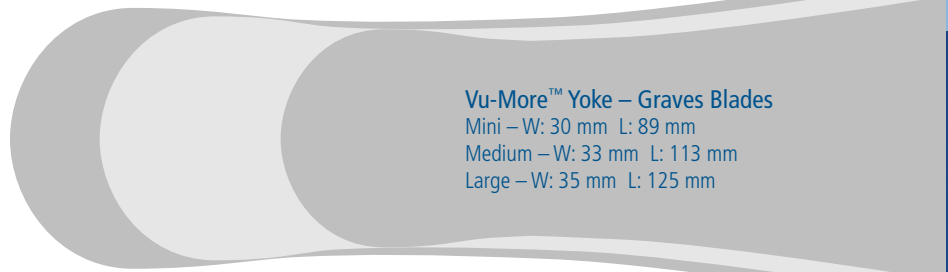

Vu-More™ Yoke – Graves Blades
Mini – W: 30 mm L: 89 mm
Medium – W: 33 mm L: 113 mm
Large – W: 35 mm L: 125 mm

Also Available with Side Opening Yoke



Standard Yoke – Pederson Blades
Virgin – W: 13 mm L: 76 mm
Small – W: 13 mm L: 81 mm
Extra Narrow – W: 17 mm L: 108 mm
Medium – W: 22 mm L: 114 mm
Large – W: 26 mm L: 121 mm

Also Available with Side Opening Yoke

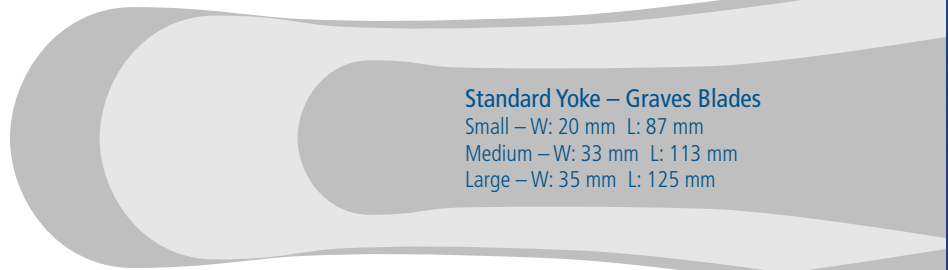

Standard Yoke – Graves Blades
Small – W: 20 mm L: 87 mm
Medium – W: 33 mm L: 113 mm
Large – W: 35 mm L: 125 mm

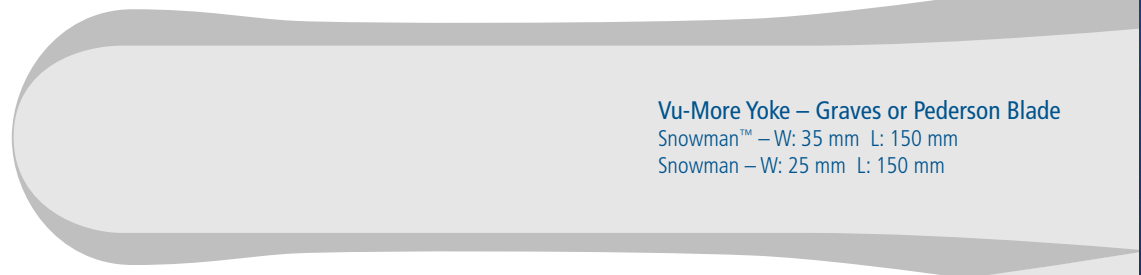

Vu-More Yoke – Graves or Pederson Blade
Snowman™ – W: 35 mm L: 150 mm
Snowman – W: 25 mm L: 150 mm



Vu-Max and Vu-More Yokes – Graves Blades
X Large – W: 35 mm L: 150 mm
2X Large – W: 35 mm L: 160 mm
3X Large – W: 35 mm L: 170 mm
4X Large – W: 35 mm L: 180 mm

Euro-Med® Stainless Steel Specula

A Higher Level of Control and Patient Comfort



Graves Speculum

Vu-More Speculum

Pederson Speculum

Graves

CA* CE

The popular Euro-Med Graves vaginal speculum features a slightly wider traditional blade design. Available with standard yoke and an open-sided configuration. The Graves blade is also available in longer lengths with a Vu-More or Vu-Max™ yoke.

Number	Description	Size mm
64-100	Small	W20 L87
64-102	Medium	W33 L113
64-104	Large	W35 L127
64-108	Open-sided	W35 L117

Pederson

CA* CE

One of the most widely used speculum designs, this model, with its slightly thinner traditional blade, is particularly useful with young or nulliparous women. The Pederson blade is also available with a Vu-Max yoke.

Number	Description	Size mm
391-671	Virgin	W13 L76
64-110	Small	W13 L81
391-674	Extra-narrow	W17 L108
64-112	Medium	W22 L114
64-114	Large	W25 L130

Vu-More™

CA* CE

The Vu-More provides a 25 percent larger viewing area at the yoke than a comparable Graves to afford easier instrumentation access and improved visibility. The Mini's short blade facilitates examinations for women with cervical prolapse.

Number	Description	Size mm
64-130	Mini	W34 L93
63-902	Medium	W33 L113
63-900	Large	W35 L127
63-905	X Large	W35 L150
63-906	2X Large	W35 L160
63-907	3X Large	W35 L170
63-908	4X Large	W35 L180

New Longer Length

(W=Distal End) (L=Penetration Length)

To place an order, call us at: 800.243.2974 | Visit us online at: www.CooperSurgical.com

**Vu-Max™**

CA* CE

The Vu-Max vaginal speculum's unique design substantially reduces the chance of obstructing the physician's view or instrument access. Offered in both Pederson and Graves configurations.

Number	Description	Size mm
64-113	Pederson Medium	W22 L114
64-115	Pederson Large	W25 L120
64-218	Graves Medium	W33 L113
64-219	Graves Large	W35 L127
64-225	X Large	W35 L150
64-226	2X Large	W35 L160
64-227	3X Large	W35 L170
64-228	4X Large	W35 L180

New Longer Length

**Snowman™**

CA* CE

Snowman specula are built using a 40 mm yoke opening for optimized strength and visualization. Designed to naturally fit the obese patient, their longer blades safely expose and access the cervix.

Number	Description	Size mm
64-107	Graves Blade	W35 L152
64-117	Pederson Blade	W25 L152
64-127	One each/Graves & Pederson	

**ExpandableView™ Integrated Speculum and Lateral Retractor**

CA* CE

ExpandableView is designed to enhance clinician visualization. Combines a traditional speculum with a lateral wall retractor to enhance the view of the cervix by retracting redundant vaginal tissue. Especially effective for large or multiparous patients.

Number	Description	Size mm
64-161	Medium	W22 L109
64-162	Large	W22 L133
64-163	Stainless Steel Instrument Holder	

**Weisman Graves Side Opening**

CA* CE

Weisman Graves specula feature an open side for improved instrument access and easy removal once instruments are placed. Available in two sizes with left or right openings.

Number	Description	Size mm
391-667A	Left side open, Med	W33 L113
391-667	Left side open, Lg	W35 L125
391-668A	Right side open, Med	W33 L113
391-668	Right side open, Lg	W35 L125

**Pederson Side Opening**

CA* CE

The Pederson open-sided specula features the traditional thinner blade design while providing the advantages of either a left or right side opening for efficient instrument access and removal.

Number	Description	Size mm
64-112L	Left side open, Med	W22 L114
64-114L	Left side open, Lg	W26 L121
64-112R	Right side open, Med	W22 L114
64-114R	Right side open, Lg	W26 L121

**Auvard**

CA* CE

This popular 2.5-pound weighted speculum is the standard for posterior vaginal wall retraction in vaginal procedures.

Number	Description	Size mm
64-422	Med (Wide/Short Blade)	W43 L68
64-421	Lg (Narrow/Long Blade)	W35 L88

Stainless Steel Lateral Wall Retractors

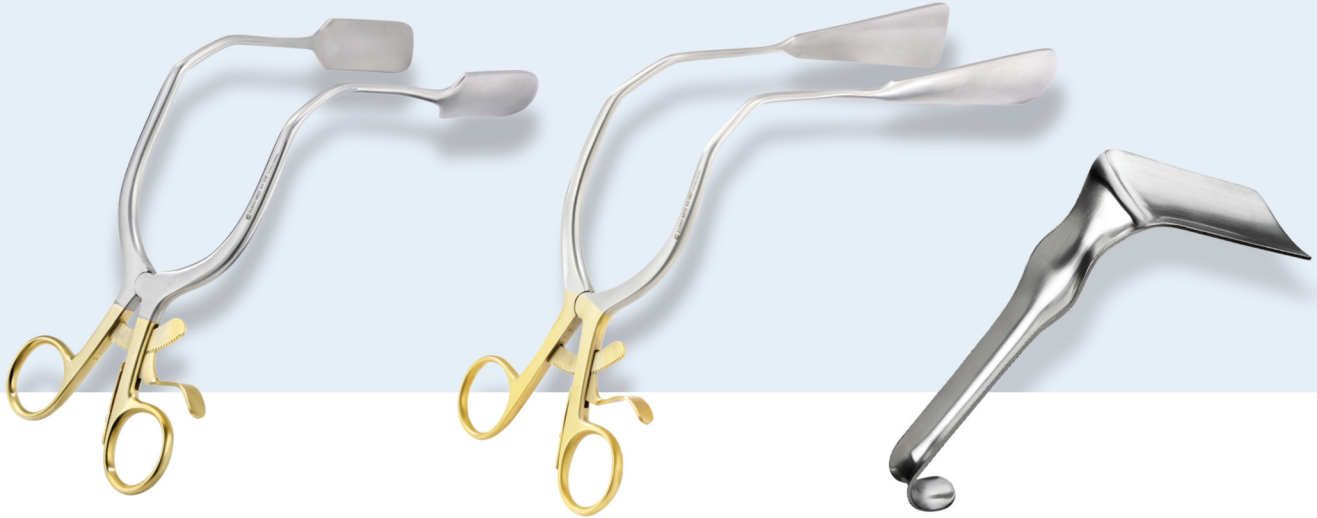

Cer-View™ Lateral Wall Retractor

CA* CE

Contoured and shaped to fit into the yoke of a standard speculum, the Cer-View retractor expands beyond the width of the speculum blades and retracts the side walls of the vaginal vault to achieve an unobstructed view of the cervical anatomy. Cer-View is especially useful in the presence of vaginal prolapse.

Number	Description	Size mm
64-310	Medium	W22 L150
64-320	Large	W22 L160

Tru-View™ Lateral Wall Retractor

CA* CE

Designed specifically for use with obese patients, the Tru-View has longer tapered blades that fit a long vaginal canal without pinching in the yoke area. The unique arm configuration provides added strength and support under prolapse conditions. Tru-View is a natural fit when combined with the Snowman™ speculum.

Number	Description	Size mm
64-307	Extra Large	W32 L190

Jackson Vaginal Retractor

CA* CE

This traditional retractor can be inserted and pulled downward to provide maximum posterior viewing. Like all Euro-Med specula and retractors, the Jackson features a polished stainless steel blade for maximum patient comfort.

Number	Description	Size mm
64-322	Medium	W40 L98
64-324	Large	W40 L115

Sounds and Dilators

Sims Uterine Sound

CA* CE



Sims Uterine Sounds are fully graduated for accurate fundal depth determination and feature a bulbous tip to reduce the risk of perforation. Part number 64-600 is made of silver-plated copper, which makes it ideal for situations where a more malleable sound is useful. Part number 64-601 is not as malleable but will resist corrosion due to its stainless steel properties. Both can adapt to virtually any anatomical variation.

Number	Description	Size
64-601	Sims Uterine Sound – Stainless Steel	L12.5"/317
64-600	Sims Uterine Sound – Silver-Plated Copper*	L12.5"/317

*Silver-plated copper may tarnish.

Dil-Os™ Uterine Sound/Dilator

CA* CE



These versatile tools safely facilitate rapid location of the cervical Os, allow conservative endocervical dilation, help the gradual opening of the internal Os, give accurate determination of uterine depths and provide the tactile determination of intrauterine adhesions and septa.

Number	Description	Size
64-336	Slight Curve	L12.7"/322
64-337	Strong Curve	L12.5"/317
64-338	Set (64-336, 64-337)	

Stainless Steel Sounds and Dilators



Mini Cervical Dilator Set CA* CE

Ideally suited for nulliparous patients or those with a stenotic Os. Includes a universal handle that holds dilator tips from sizes 1 to 3 mm in half-millimeter increments. Rounded dilator tips help prevent uterine wall puncture.

Number	Description
64-374	5 Dilators, Handle and Storage Pouch



Small Cervical Dilator Set CA* CE

This small cervical dilator set is designed for patients with a stenotic cervical Os. Set of six dilators including sizes 1 through 6 mm. Comes in a fitted and numbered storage pouch.

Number	Description
64-372	6 Dilators and Storage Pouch



Hank Cervical Dilators CA* CE

Hank cervical dilators come in a set of six or individually, ranging from 9 French (3 mm) to 20 French (6.66 mm). The set comes in a custom-fitted and numbered pouch for easy storage and selection.

Number	Size mm
64-370	6 Dilators and Storage Pouch
61201	9/10 Fr
61202	11/12 Fr
61203	13/14 Fr
61204	15/16 Fr
61205	17/18 Fr
61206	19/20 Fr

Hegar Dilator Set CA* CE



Stainless steel Hegar dilators provide the option of double-ended dilators in even millimeter increments from 3 to 18 for a greater diameter range over the entire set. Each double-ended dilator is custom-labeled accordingly. Sold in a set of eight or individually for added convenience.

Number	Size mm
61207	3/4 - 17/18 (8/Set)
61208	3/4
61209	5/6
61210	7/8
61211	9/10
61212	11/12
61213	13/14
61214	15/16
61215	17/18

Pratt Dilator Set CA* CE



Stainless steel Pratt dilators offer the largest diameters in our line of cervical dilators, ranging from 13 French (4.3 mm) to 59 French (19.6 mm). Each is double-ended and custom-labeled accordingly in French scale measurements. Sold in a set of eight or individually for added convenience.

Number	Size
391-830	13/15 Fr – 41/43 Fr (8/Set)
391-833	13/15 Fr
391-834	17/19 Fr
391-835	21/23 Fr
391-836	25/27 Fr
391-837	29/31 Fr
391-838	33/35 Fr
391-839	37/39 Fr
391-840	41/43 Fr
391-841	45/47 Fr
391-842	49/51 Fr
391-843	53/55 Fr
391-844	57/59 Fr

To place an order, call us at: 800.243.2974
Visit us online at: www.CooperSurgical.com

Stainless Steel Endocervical Curettes

Kevorkian with Basket CA* CE



A narrow tip permits sampling without dilation, while the stainless steel blade resists clogging and dulling. With basket for sample retention.

Number	Length
66-442	12"/305 mm

Kevorkian without Basket CA* CE



Handle Style

Like the Kevorkian with basket, this curette's design is traditionally weighted for optimal balance and control.

Number	Length
66-440	12"/305 mm

Townsend™ CA* CE



The rounded and tapered tip facilitates entry through a stenotic Os. The design of the cutting edge yields improved endocervical sampling.

Number	Length
66-445	12.3"/312 mm

Kevorkian Collector™ CA* CE



Another Euro-Med exclusive with a unique basket that offers greater assurance of sample retention. Rounded tip facilitates cervical entry.

Number	Length
66-441	12"/305 mm

London™ CA* CE



The flanged basket facilitates sample collection and ensures optimal sample retention while exiting. The design also incorporates a rounded, tapered tip to permit nontraumatic entry into a stenotic Os.

Number	Length
64-490	11.5"/292 mm

Endocrette™ CA* CE

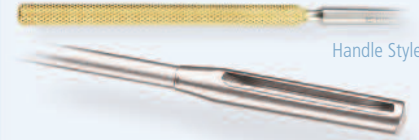

Handle Style

Our revolutionary design allows optimal sample collection with a simple swirl motion – no pushing or pulling. Closed blade on both ends eliminates the chance of sample loss and reduces patient discomfort.

Number	Length
66-447	12.3"/312 mm

Endometrial Curettes

Novak CA* CE



Our most popular reusable endometrial sampler. Features a suction attachment for improved sampling.

Number	Size	Length
64-624	1 mm	9.6"/244 mm
64-626	2 mm	9.6"/244 mm
64-628	3 mm	9.6"/244 mm
64-630	4 mm	9.6"/244 mm

Randall CA* CE



Handle Style

The less aggressive Randall endometrial sampler also has a suction attachment for improved sample collection.

Number	Size	Length
64-620	3.9 mm	10"/254 mm

Sims CA* CE



Handle Style

The premier choice for uterine curettage. Sharp and malleable, they come in many different sizes and are an industry standard 11 inches long.

Number	Size	Length
392-110	0 (5 mm)	11"/280 mm
392-111	1 (7 mm)	11"/280 mm
392-112	2 (9 mm)	11"/280 mm
392-113	3 (11 mm)	11"/280 mm
392-114	4 (13 mm)	11"/280 mm

Mini Vu-More™ LEEP Specula

CA★ CE

This speculum features very short blades to facilitate examination of patients with cervical prolapse or very short vaginal canals.

Number	Size mm
F250	W34 L93

**Open-Sided LEEP Specula**

CA★ CE

This vaginal speculum features a sturdy one-sided hinge arrangement for improved instrument access and visibility.

Number	Size mm
F210	W35 L107

**Auvard Surgical Specula**

CA★ CE

This 2.5-pound weighted speculum can be used safely in any operative vaginal procedure where the use of electrosurgery is anticipated.

Number	Description	Size mm
F230	Medium (Wide/ Short Blade)	W43 L55
F232	Large (Narrow/ Long Blade)	W35 L90

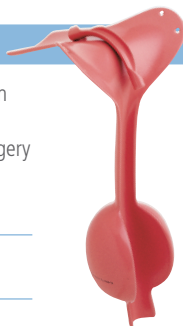
**Jackson LEEP Retractor**

CA★ CE

This coated retractor can be inserted and pulled downward to provide maximum posterior viewing.

Number	Description	Size mm
F235	Medium	W40 L89
F234	Large	W40 L108

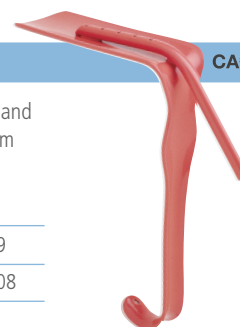
**Cer-View™ LEEP Lateral Wall Retractor**

CA★ CE

Retracting redundant vaginal tissue, Cer-View provides increased exposure of the cervix, especially important when vaginal prolapse is an issue or with nulliparous patients. Contoured and shaped to fit into the yoke of a standard speculum and expand beyond the width of the speculum blades for an unobstructed view.

Number	Description	Size mm
F410	Medium	W22 L142
F420	Large	W22 L155

**Tru-View™ LEEP Lateral Wall Retractor**

CA★ CE

Naturally fitting the obese patient, the Tru-View features longer blades to safely expose and access the cervix. Provides added strength and support under prolapse conditions. The perfect complement to the Snowman Speculum.

Number	Description	Size mm
F317	Lateral Wall Retractor	W32 L190

**Graves Specula (with Integrated Smoke Tube)**

CA★

This popular vaginal speculum features the standard Graves blades and incorporates an integrated smoke tube. Available in three sizes.

Number	Description	Size mm
61513	Small	W22 L87
61514	Medium	W33 L113
61515	Large	W35 L125

**Pederson LEEP Specula (with Integrated Smoke Tube)**

CA★

This model is specifically modified for electrosurgical applications. The narrow blades are more comfortable for your smaller patients or those with a narrow vaginal canal. Features integrated smoke tube. Available in three sizes.

Number	Description	Size mm
61521	Small	W16 L84
61518	Medium	W22 L114
61519	Large	W26 L121

